



EVANSTON PARK - Unique Family Living With Panoramic Views

\$389,950

Situated at the top of Evanston Park this stunning home is one that must be seen to be believed.

This character-filled home has been completely renovated, with a brand new kitchen and formal dining room, and new wooden floor boards throughout. The large lounge room and separate family/rumpus both lead out onto decking with scenic views over the majestic Adelaide Plains. The home boasts 2 king size bedrooms both with built-in-robos, the master bedroom also has a large ensuite.

Bedroom 2 is located upstairs along with the family bathroom and another large living area which could easily be used as a third bedroom, upstairs also has a balcony with breathtaking views.

The home is heated and cooled by reverse cycle split systems in every room and is serviced by a new hot water service and a 3kw solar system ??? enough to say goodbye to annoying electricity bills!

Set on almost 800m² the grounds are fully landscaped and low maintenance, with the added bonus of a self-sustainable vegetable garden and potting sheds. There is also an in-ground salt water swimming pool surrounded by Balinese style tropical plants, perfect for entertaining during summer! Rear access to the property is also available.

This unique character home is one not to be missed!

RLA 249396

Upcoming Inspections

Inspect by appointment, contact agent.

Land Size

797 m²

Kies Real Estate

enquiries@kies.com.au

08 8523 3777

3A Adelaide Road, Gawler 5118

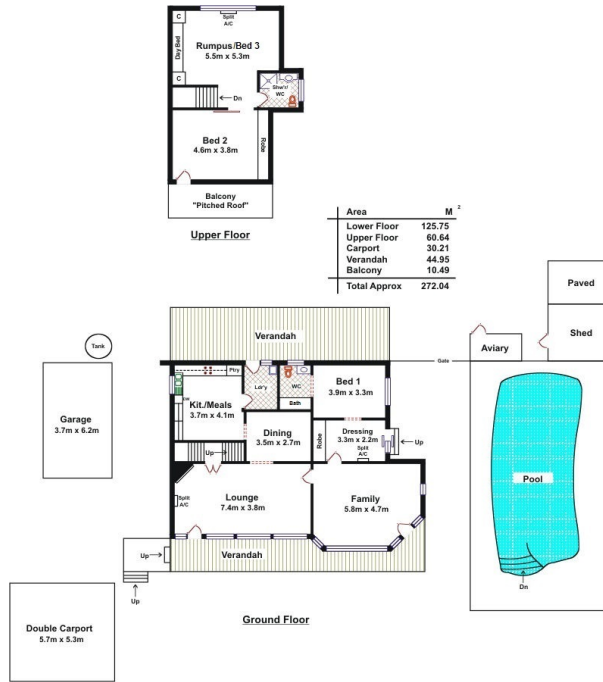

Please Note: Every care has been taken to verify the correctness of the areas and details used in this leaflet. No warranty or representation is given or made as to the correctness of the information supplied and neither the owners, RealEstate.com.au nor the Agents can accept responsibility for errors or omissions. The sketch is for illustration purposes only and intending purchasers should satisfy themselves independently regarding sizes, layout and location of the property. Please check with local council that all structures are approved by council.

