



LYNDOCH - Family Living In The Perfect Country Location

\$399,950

If you are looking for a rural family home with room to move then this property should be on your list. Located on the edge of the beautiful Barossa Valley in the town of Lyndoch this massive 5552m² property is conveniently close to schools, parks and shops but still offers the potential to breathe in that fresh country air.

Built in 1986 this well presented home boasts 4 bedrooms, including a spacious master with walk-in-robe. Bedrooms 2 and 3 offer built in robes and ceiling fans.

There is an open plan meals, lounge and family living area adjacent to the kitchen which is complete with dishwasher and ample cupboard space. Ducted reverse cycle heating and cooling keeps the family comfortable year-round.

The property also boasts an above-ground swimming pool with decking, outdoor entertaining area and ample storage facilities with 2 sheds.

Opportunities to purchase properties such as this on a large parcel of land in the Barossa Valley rarely arise and this one won't last long, so call us today to arrange an inspection!

RLA 249396

Upcoming Inspections

Inspect by appointment, contact agent.

Land Size

5552 m²

Kies Real Estate

enquiries@kies.com.au

08 8523 3777

3A Adelaide Road, Gawler 5118

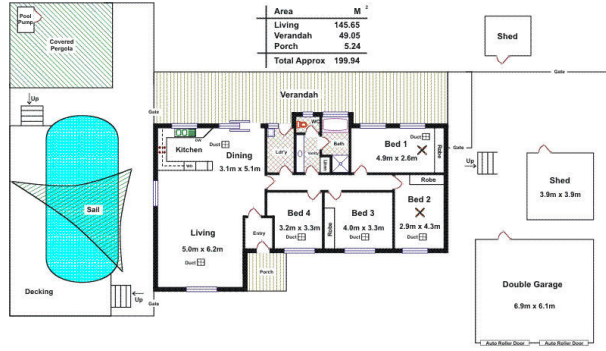

Please Note: Every care has been taken to verify the correctness of the areas and details used in this leaflet. No warranty or representation is given or made as to the correctness of the information supplied and neither the agent, licensor or the Agents can accept responsibility for errors or omissions. The sketch is for illustration purposes only and intending purchasers should satisfy themselves independently regarding size, layout and location of the property. Please check with local council that all structures are approved by council.

