



## **GAWLER EAST - Seek and You Will Find!**

\$359,950

Set in a wonderfully quiet court amongst other quality homes, with sweeping views and Gawler East and Hewett sits this beautiful stone-fronted home. Set on 809m<sup>2</sup>, there is excellent access to the 9m x 6m shed, as well as double garage with automatic rollers doors under the main roof.

The home features 3 double bedrooms with built-in-robos, with two-way bathroom servicing the main as ensuite; together with formal lounge, formal dining, and a spacious kitchen / family area. This home is complete in every detail, with ducted evaporative air-conditioning, gas heating, and instant gas hot water.

The home boasts quality soft furnishings and excellent fixtures and fittings. Outside is also complete with established gardens and a superb rear verandah, taking full advantage of the stunning elevated views.

Inspection is by appointment and will not disappoint. Find what you have been seeking and call today to arrange a time to suit.

RLA: 249396

## **Upcoming Inspections**

Inspect by appointment, contact agent.

## **Land Size**

809 m<sup>2</sup>

## **Kies Real Estate**

[enquiries@kies.com.au](mailto:enquiries@kies.com.au)

08 8523 3777

3A Adelaide Road, Gawler 5118

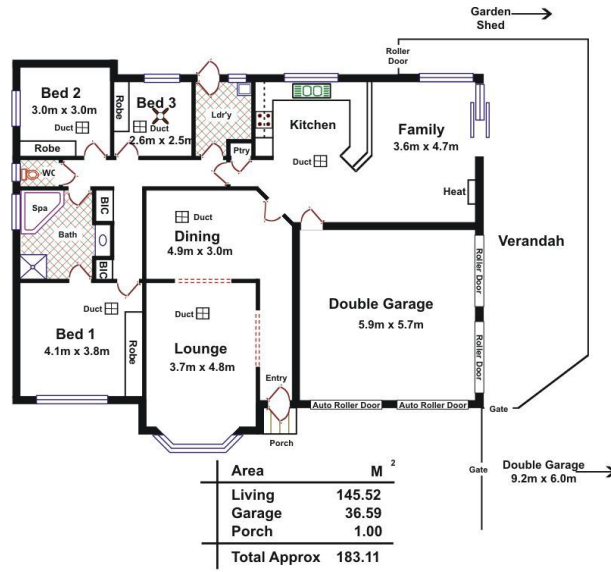

Please Note: Every care has been taken to verify the correctness of the areas and details used in this leaflet. No warranty or representation is given or made as to the correctness of the information supplied and neither the owners, illustrator nor the Agents can accept responsibility for errors or omissions. The sketch is for illustration purposes only and intending purchasers should satisfy themselves independently regarding sizes, layout and location of the property. Please check with local council that all structures are approved by council.

