



WEST HINDMARSH - Circa 1920 Villa

\$495,000

A great location and even greater character! Offering three double bedrooms, main with wall-to-wall built in robes; together with huge kitchen / meals area with plenty of cupboard space and dishwasher. And to add to the charm, both bedroom 2 and the formal lounge boast beautiful original fireplaces.

This home blends modern with yesteryear, with sparkling bathroom and second toilet, high ceilings throughout, central hallway and polished floorboards. Set on approximately 400m² with beautifully established gardens, double carport under the main roof, and 3.3m x 5.7m workshop, this property is wonderfully neat and complete.

Inspection by appointment, call to arrange a time to suit.

RLA: 249396

Upcoming Inspections

Inspect by appointment, contact agent.

Land Size

400 m²

Kies Real Estate

enquiries@kies.com.au

08 8523 3777

3A Adelaide Road, Gawler 5118

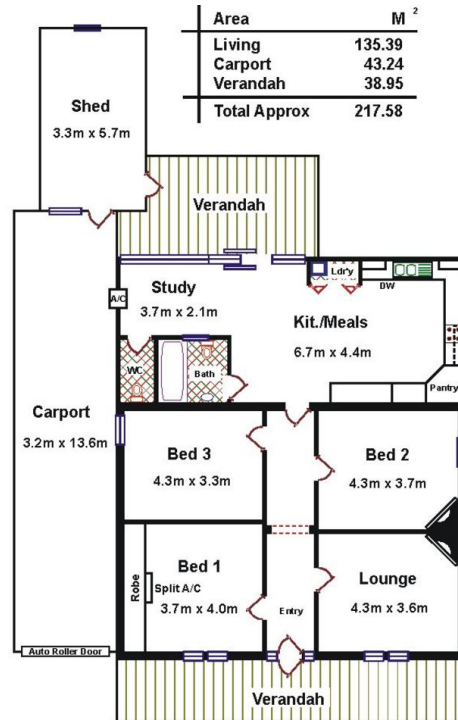

Please Note: Every care has been taken to verify the correctness of the areas and details used in this leaflet. No warranty or representation is given or made as to the correctness of the information supplied and neither the owners, illustrator nor the Agents can accept responsibility for errors or omissions. The sketch is for illustration purposes only and intending purchasers should satisfy themselves independently regarding sizes, layout and location of the property. Please check with local council that all structures are approved by council.

