



GAWLER EAST - A Great Home for a Growing Family

\$274,950

Ideally placed on a 671m2 corner block is this lovely home in the heart of Gawler East. With three bedrooms plus a study which could easily be used as a fourth bedroom, if desired, the home is a wonderful place for a growing family.

The wonderful high ceilings throughout give a sense of light and space to this well maintained property, and the polished timber floors leading through to the large formal lounge are a beautifully modern touch. The sparkling kitchen is the heart of the home, and leads onto both the lounge and the sunroom / meals area ??? a perfect space for relaxing, or as a games room for the kids!

Outside, the large pergola provides the shelter for an entertainment area overlooking the well-kept, low-maintenance gardens.

This great family home boasts the ideal location ??? in the lovely suburb of Gawler East, close to local schools and all of Gawler???'s amenities ??? and is sure to impress upon inspection. Call Kies today to arrange a time to suit.

RLA: 249396

Upcoming Inspections

Inspect by appointment, contact agent.

Land Size

671 m2

Kies Real Estate

enquiries@kies.com.au

08 8523 3777

3A Adelaide Road, Gawler 5118

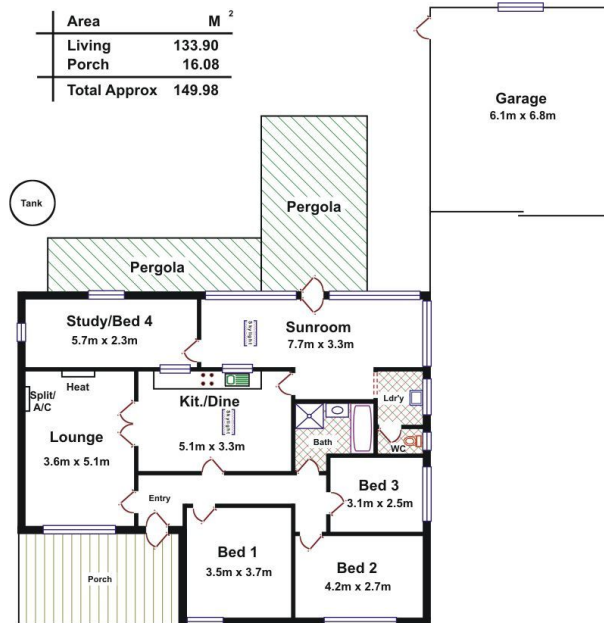

Please Note: Every care has been taken to verify the correctness of the areas and details used in this leaflet. No warranty or representation is given or made as to the correctness of the information supplied and neither the owners, illustrator nor the Agents can accept responsibility for errors or omissions. The sketch is for illustration purposes only and intending purchasers should satisfy themselves independently regarding sizes, layout and location of the property. Please check with local council that all structures are approved by council.

