



ELIZABETH VALE - Opportunity Knocks!

\$184,950

This well maintained and neatly presented 3 bedroom home is located in a quiet part of Elizabeth Vale, close to all amenities and only 5 minutes from Elizabeth shopping precinct. Set on a great sized allotment of 689m², the home features 3 huge bedrooms, a large lounge room, family/rumpus room and a spacious kitchen and meals area. Roller shutters provide great security and the whole home is serviced by ducted reverse cycle heating and cooling.

Outside adds further appeal to the property, with a carport, large rear veranda and a garden shed. The gardens are established with a complete dripper system for easy maintenance.

This home is ideal for first home buyers or investors looking to add to their portfolio. Call us today to arrange your private inspection.

RLA: 249396

Upcoming Inspections

Inspect by appointment, contact agent.

Land Size

689 m²

Kies Real Estate

enquiries@kies.com.au

08 8523 3777

3A Adelaide Road, Gawler 5118

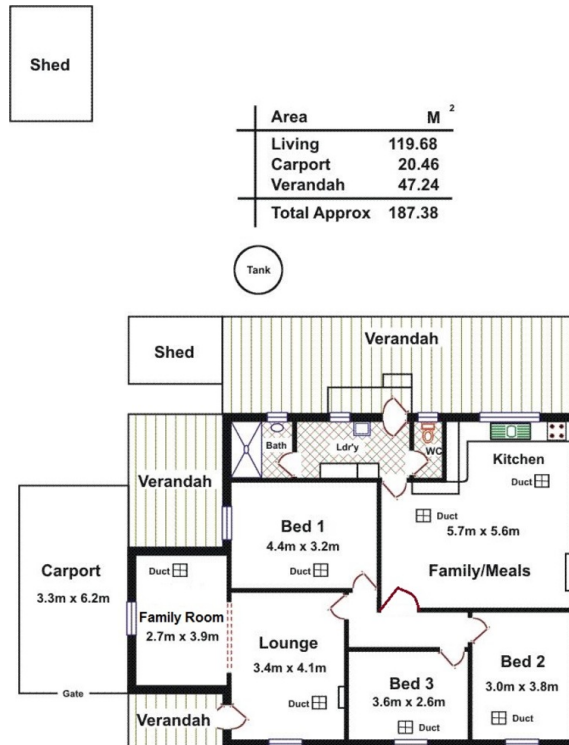

Please Note: Every care has been taken to verify the correctness of the areas and details used in this leaflet. No warranty or representation is given or made as to the correctness of the information supplied and neither the owners, illustrator nor the Agents can accept responsibility for errors or omissions. The sketch is for illustration purposes only and intending purchasers should satisfy themselves independently regarding sizes, layout and location of the property. Please check with local council that all structures are approved by council.

