

Land:

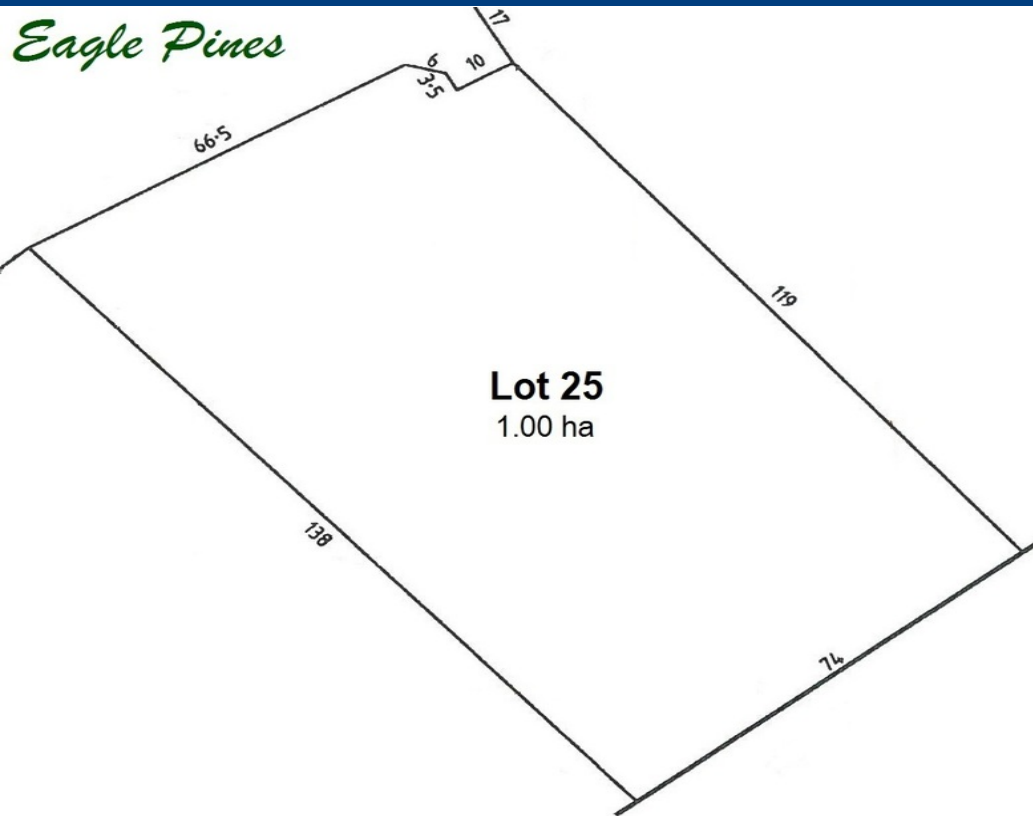

Eagle Pines - Sandy Creek - Contact Kies Real Estate (08) 8523 3777



Allot	Area m ²	Price
Lot 21	1.00 ha	\$329,950
Lot 22	1.00 ha	\$439,950
Lot 23	1.00 ha	SOLD
Lot 24	1.00 ha	SOLD
Lot 25	1.00 ha	\$329,950
Lot 26	1.00 ha	\$329,950

With a choice of an Established Residence or 3 Vacant Allotments, these Stunning Home Sites offer you the Ultimate Lifestyle for the Whole Family

- Secluded 1.00 hectare Allotments - Fully serviced with Power and Water - Private Gated Community



SANDY CREEK - Lot 25 Eagle Pines

\$329,950

At the gateway of the Barossa valley, in the quiet town of Sandy Creek, sits Eagle Pines. With serene views of the Gawler Golf Course this exclusive land release offers a choice of six prime allotments of a generous 1.00 hectares with prices starting from \$329,950.

Four of the stunning allotments are vacant land and are awaiting plans for your dream home, and Lot 22 contains an existing residence, just waiting for you to move in. These allotments are serviced with power and water, and the quiet cul-de-sac is gated, giving you the A-list treatment with a relaxed country feel and a safe environment for the kids.

Conveniently located minutes from Gawler and the Barossa Valley, Eagle Pines treats you to the convenience of shopping in Gawler or relaxing with restaurants and wine tasting in the Barossa.

With our lives getting busier and land sizes getting smaller, this is your chance to acquire a stunning allotment to build your dream home or simply move into one of the beautifully established homes within Eagle Pines - a gated community where you can take a deep breath and relax.

RLA: 249396

Upcoming Inspections

Inspect by appointment, contact agent.

Land Size

2.47 m2

Kies Real Estate

enquiries@kies.com.au

08 8523 3777

3A Adelaide Road, Gawler 5118

Land:

