



DAVOREN PARK - Paradise Found!

\$209,950

Built on a spacious 658m2 allotment, this modern home truly feels like being on holiday! Fully renovated both inside and out, this home is sure to please.

From the entry way, through the lounge with a gas fireplace, this home is quality in every detail. With three good-sized bedrooms, a fully renovated bathroom, and an immaculate kitchen and dining area that will take your breath away!

If the inside isn't enough, the outside will certainly grab you with a great entertaining area with verandah and shading sails, and a large shed for all of your DIY needs.

Inspection is by appointment call to arrange a time to suit.

RLA: 249396

Upcoming Inspections

Inspect by appointment, contact agent.

Land Size

658 m2

Kies Real Estate

enquiries@kies.com.au

08 8523 3777

3A Adelaide Road, Gawler 5118

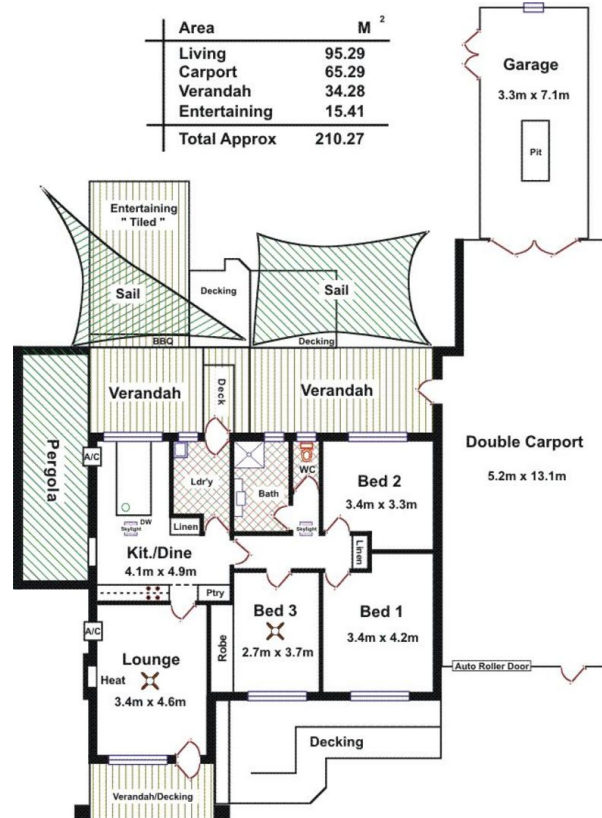

Please Note: Every care has been taken to verify the correctness of the areas and details used in this leaflet. No warranty or representation is given or made as to the correctness of the information supplied and neither the owners, illustrator nor the Agents can accept responsibility for errors or omissions. The sketch is for illustration purposes only and intending purchasers should satisfy themselves independently regarding sizes, layout and location of the property. Please check with local council that all structures are approved by council.

