

**BIBARINGA - Views All the Way to the Coast**

\$534,950

Situated on over 10 acres, with views all the way out to the coast, this property is surprisingly only 5 minutes from the heart of Gawler. With local wineries just round the corner, it is the ideal location for a tree-change.

The home boasts four spacious and bright bedrooms; the master bedroom offers an ensuite and walk-in-robe. The 3-way family bathroom is situated near bedrooms 2, 3 and 4, away from the main living areas.

There are two separate living areas; a family/rumpus room off the kitchen, and a formal lounge/dining area at the front of the home. A massive slow combustion heater and reverse-cycle heating and cooling system service the home.

Outside you are greeted by 10 acres of pure potential, with the property including a large 6.2m x 9.2m shed/workshop, and a bore which feeds into the rainwater tanks. The land was once used as a hobby farm for olives, but is now ready for your own creation.

This is a rare opportunity to purchase a large home on acreage. Call today to arrange your private inspection.

RLA: 249396

**Upcoming Inspections**

Inspect by appointment, contact agent.

**Land Size**

10 m2

**Kies Real Estate**

[enquiries@kies.com.au](mailto:enquiries@kies.com.au)

08 8523 3777

3A Adelaide Road, Gawler 5118

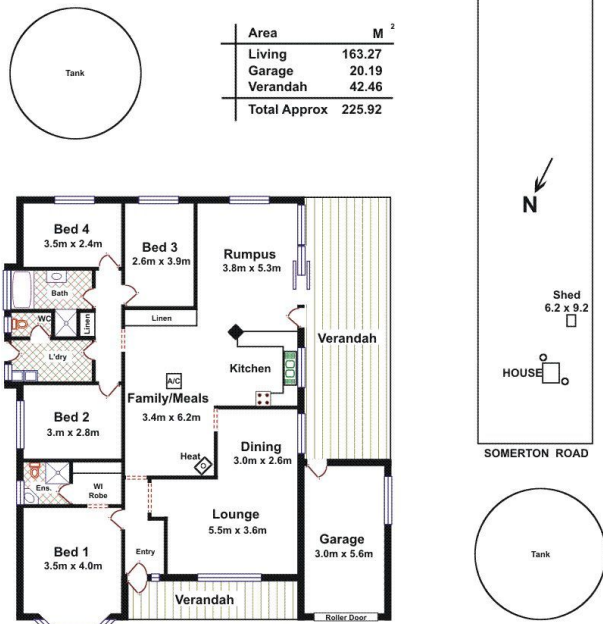

Please Note: Every care has been taken to verify the correctness of the areas and details used in this leaflet. No warranty or representation is given or made as to the correctness of the information supplied and neither the owners, illustrator nor the Agents can accept responsibility for errors or omissions. The sketch is for illustration purposes only and intending purchasers should satisfy themselves independently regarding sizes, layout, and location of the property. Please check with local council that all structures are approved by council.

