



## **GAWLER SOUTH - Travel Back in Time...**

\$299,950

Built in a bygone era, this 1890 symmetrical cottage is a must for anyone looking for the old world ??? a true reflection of Gawler???'s past, with all its charm and comfort.

With two bedrooms, and a living area that has been converted into a third, this home is ideal for a small family. The open-plan kitchen overlooks the family / dining area, and the lovely, spacious lounge makes entertaining easy. Complete with shed, garage, and double carport on a 658m2 block, there is enough room for all!

This is a wonderful opportunity to make a piece of local history your own ??? call Kies today to arrange an inspection to suit.

RLA: 249396

## **Upcoming Inspections**

Inspect by appointment, contact agent.

## **Land Size**

658 m2

## **Kies Real Estate**

[enquiries@kies.com.au](mailto:enquiries@kies.com.au)

08 8523 3777

3A Adelaide Road, Gawler 5118

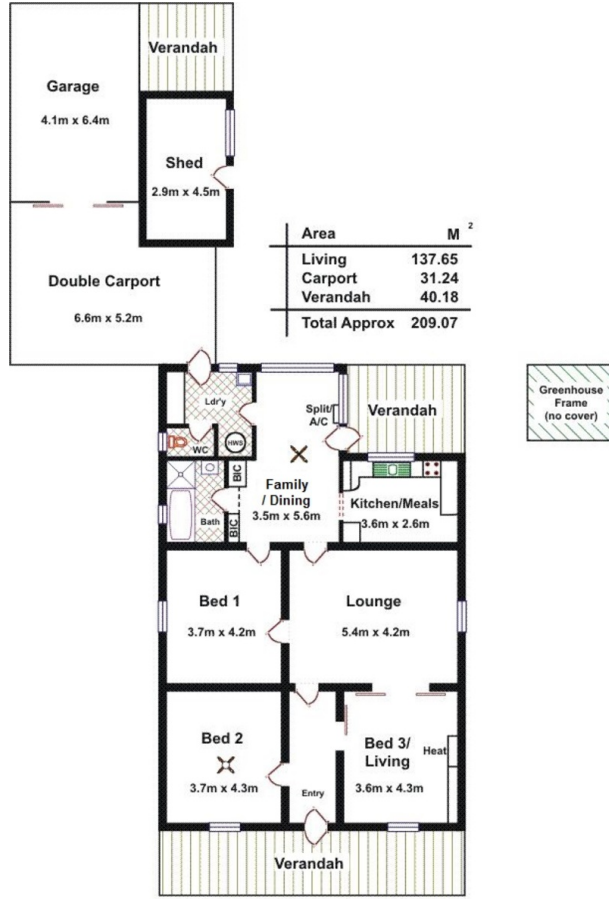

**Please Note:** Every care has been taken to verify the correctness of the areas and details used in this leaflet. No warranty or representation is given or made as to the correctness of the information supplied and neither the owners, illustrator nor the Agents can accept responsibility for errors or omissions. The sketch is for illustration purposes only and intending purchasers should satisfy themselves independently regarding sizes, layout and location of the property. Please check with local council that all structures are approved by council.

