



RIDGEHAVEN - Idyllic Lifestyle

\$384,950

This immaculately presented family home is set on a generous 740m² allotment, with easy access to major roads and public transport. Located in the quiet and leafy suburb of Ridgehaven, the property is a stone's throw from six quality schools, recreational/sporting facilities and only 5 minutes from Tea Tree Plaza Shopping centre.

This charming home features three bedrooms, all with built in robes. A neat, central kitchen, family bathroom, formal lounge and dining, and second family/living room complete the home. A slow combustion heater and ducted evaporative air-conditioning keep you comfortable year round.

The current owners have done a fantastic job of modernising the property, including an updated kitchen with new stainless steel appliances, a full roof restoration, and outside entrance decking area. To top it all off, outside there is a large entertaining area surrounded by established gardens - perfect for all your family gatherings!

A quality property in a fantastic location! Call us today to arrange an inspection to suit.

RLA: 249396

Upcoming Inspections

Inspect by appointment, contact agent.

Land Size

740 m²

Kies Real Estate

enquiries@kies.com.au

08 8523 3777

3A Adelaide Road, Gawler 5118

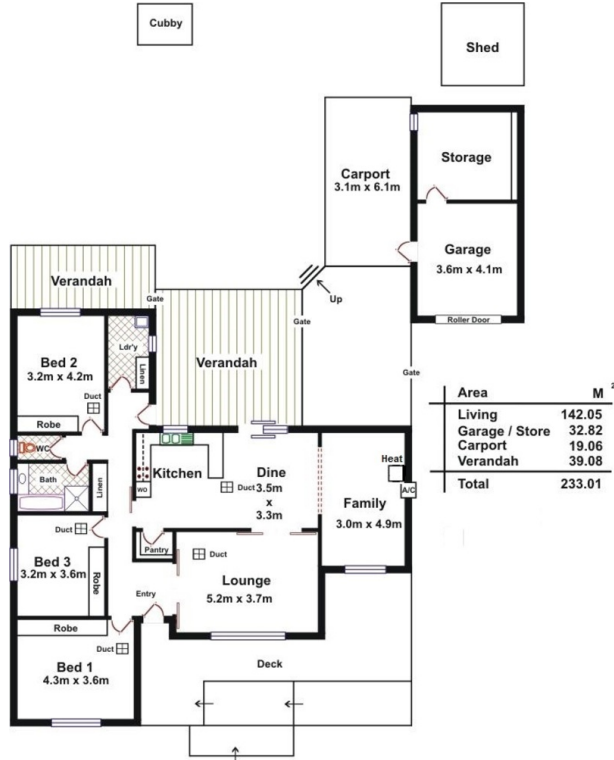

Please Note: Every care has been taken to verify the correctness of the areas and details used in this leaflet. No warranty or representation is given or made as to the correctness of the information supplied and neither the owners, illustrator nor the Agents can accept responsibility for errors or omissions. The sketch is for illustration purposes only and intending purchasers should satisfy themselves independently regarding sizes, layout and location of the property. Please check with local council that all structures are approved by council.

