

GAWLER EAST - A Must To Inspect

\$299,950

This wonderful family home is set on a 610m² allotment located in the quiet suburb of Gawler East, only 5 minutes away from all amenities and public transport.

The home comprises of three bedrooms, bedroom 1 featuring built-in robe and ensuite, main bathroom with separate toilet, a formal lounge, central dining area and a renovated kitchen that overlooks the dining area and outside entertaining area boasting serene views of the rolling hills through a fine line of gum trees. The paved entertaining area spans the entire length of the home, with a central pitched roof and established fern garden and pond on either side.

This home also comes complete with a 1.5kW solar system and reverse cycle heating and cooling.

Be it your first home, an investment, or an opportunity to downsize, this home is sure to suit.

Call today to arrange a private inspection.

RLA 249396

Upcoming Inspections

Inspect by appointment, contact agent.

Land Size

610 m²

Kies Real Estate

enquiries@kies.com.au

08 8523 3777

3A Adelaide Road, Gawler 5118

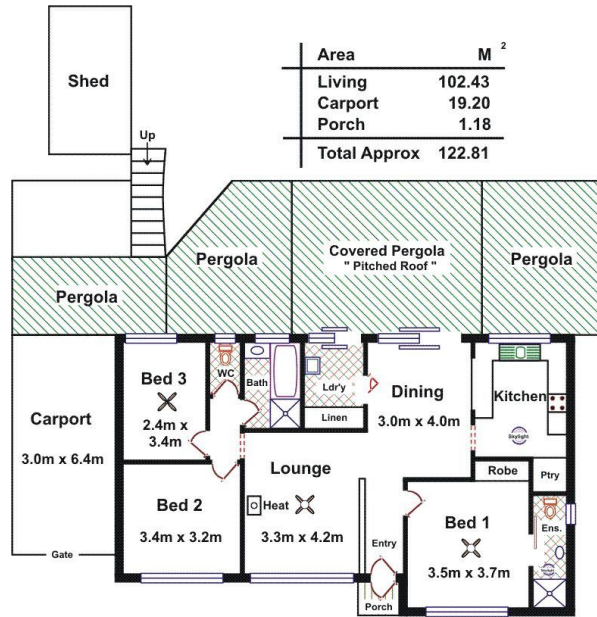

Please Note: Every care has been taken to verify the correctness of the areas and details used in this leaflet. No warranty or representation is given or made as to the correctness of the information supplied and neither the owners, illustrator nor the Agents can accept responsibility for errors or omissions. The sketch is for illustration purposes only and intending purchasers should satisfy themselves independently regarding sizes, layout and location of the property. Please check with local council that all structures are approved by council.

