



HAMLEY BRIDGE - Breathe the Country Air!

\$245,000

Located in the historic and picturesque township of Hamley Bridge, this well-maintained home offers the perfect escape to a relaxed, country lifestyle. Set on 1,735m² with established, low-maintenance gardens; take the opportunity to immerse yourself in your own quiet world, or explore the possibility of subdividing, subject to council consent.

Built in 1983, the home has been well cared for, and offers three bedrooms, including spacious master with built in robe. The modern kitchen looks out over the open family/meals area featuring large gas combustion heater and offering access to the huge outdoor pergola with its beautiful greenery. There is also a separate lounge, and ducted evaporative air conditioning throughout.

Outdoors, the irrigated gardens have their own rainwater tank, as well as three sheds, two banks of aviaries, and a chook run. With carport to the side of the house, and an additional 12m x 6m garage, you can house your vehicles with ease.

Only 15 minutes from Roseworthy Agricultural College and conveniently close to the local school, parks, and shops, this home offers both privacy and a sense of community. Call Kies today for your private inspection of this fantastic rural property.

RLA: 249396

Upcoming Inspections

Inspect by appointment, contact agent.

Land Size

1735 m²

Kies Real Estate

enquiries@kies.com.au

08 8523 3777

3A Adelaide Road, Gawler 5118

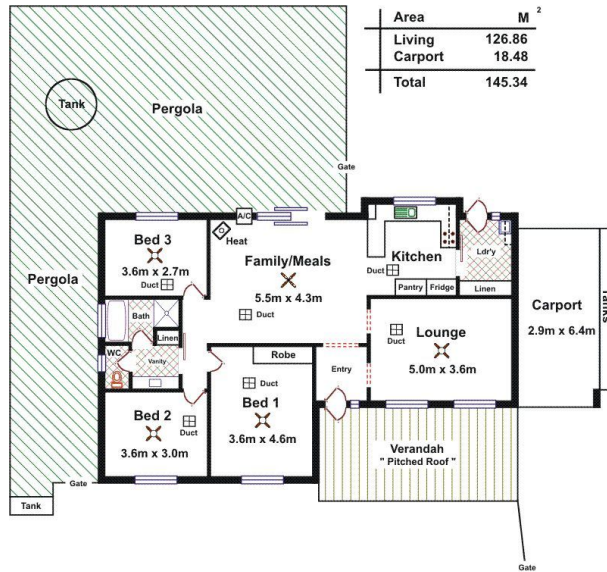

Please Note: Every care has been taken to verify the correctness of the areas and details used in this leaflet. No warranty or representation is given or made as to the correctness of the information supplied and neither the owners, illustrator nor the Agents can accept responsibility for errors or omissions. The sketch is for illustration purposes only and intending purchasers should satisfy themselves independently regarding sizes, layout and location of the property. Please check with local council that all structures are approved by council.

