



## EVANSTON PARK - Great Value!

\$299,950

Located in Evanston Park, this fantastic property is situated on a 743m<sup>2</sup> allotment. Boasting four bedrooms; master and bedrooms 2 & 3 with built in robes, and a guest bedroom located at the rear of the house ? ideal for family or friends.

The kitchen and dining area have both been fully renovated, and are smoothly united by the stunning slate flooring. The kitchen features dishwasher, stainless steel appliances, and ample cupboard space, while the dining area has been fitted with a slow combustion heater for those cozy winter evenings.

The home contains two living areas ? the formal lounge in the front, and the huge family room at the back of the house which features raked ceilings and bar, with split system cooling and a stunning open fireplace to keep you comfortable all year round.

Outdoors features a verandah overlooking the gardens, which are well established and easily maintained. There is a double carport under the main roof, 5.7m x 7.3m shed / garage that can easily accommodate an additional two cars, as needed, as well as two other 3m x 3m sheds ? perfect for all of your storage, or perhaps for your very own workshop.

This lovely home has it all, and is ready for you to move into now! Inspection is by appointment and is sure to impress. Call Kies today to arrange a time to suit.

RLA: 249396

## Upcoming Inspections

Inspect by appointment, contact agent.

## Land Size

743 m<sup>2</sup>

## Kies Real Estate

[enquiries@kies.com.au](mailto:enquiries@kies.com.au)

08 8523 3777

3A Adelaide Road, Gawler 5118

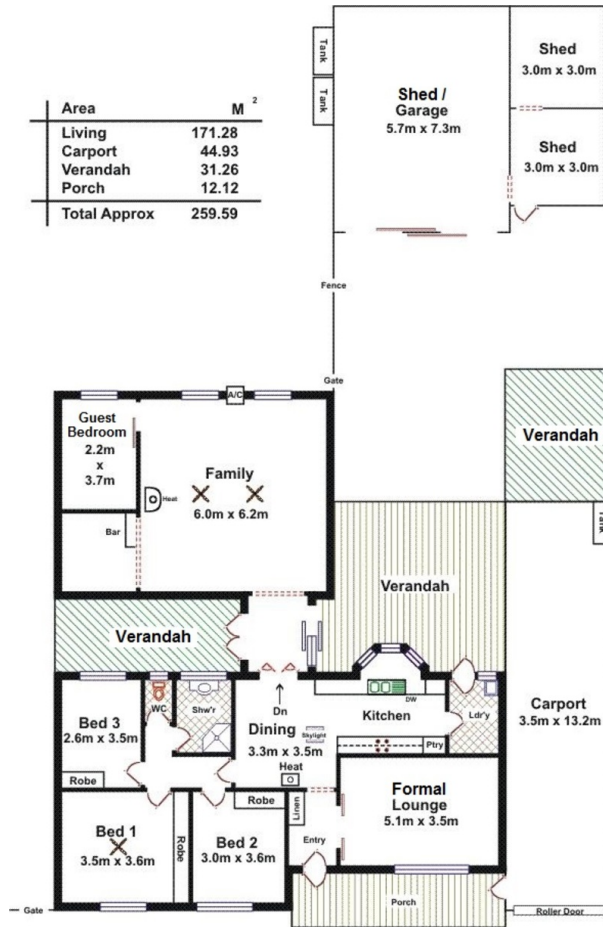

**Please Note:** Every care has been taken to verify the correctness of the areas and details used in this leaflet. No warranty or representation is given or made as to the correctness of the information supplied and neither the owners, illustrator nor the Agents can accept responsibility for errors or omissions. The sketch is for illustration purposes only and intending purchasers should satisfy themselves independently regarding sizes, layout and location of the property. Please check with local council that all structures are approved by council.

