



ELIZABETH GROVE - Start With This One

\$179,950

Situated on a 552m2 corner allotment, this offering is ideal for first home buyers or investors looking to expand their portfolio. Located next to a reserve and just minutes away from schools, shops, and public transport, convenience like this can't be beat!

This property presents a unique layout, with the bedrooms positioned away from the living areas, for peace and quiet. The home features two separate living areas plus sunroom, kitchen and dining that is sure to please, and is rounded out with a large laundry, and bathroom with separate toilet.

Outside boasts a large entertaining area with verandah shading, which leads through to the large separate rumpus room ? the perfect games room, studio, or teenage retreat! Also featuring ducted reverse cycle heating and cooling, double carport, and tidy, low-maintenance gardens, this is a wonderful home just waiting for a new start.

Inspection is by appointment, call today to arrange a time to suit.

RLA: 249396

Upcoming Inspections

Inspect by appointment, contact agent.

Land Size

552 m2

Kies Real Estate

enquiries@kies.com.au

08 8523 3777

3A Adelaide Road, Gawler 5118

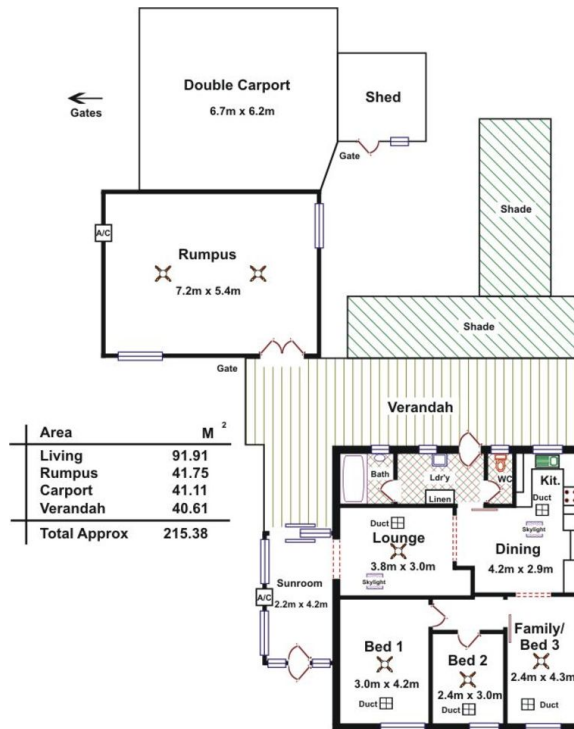

Please Note: Every care has been taken to verify the correctness of the areas and details used in this leaflet. No warranty or representation is given or made as to the correctness of the information supplied and neither the owners, illustrator nor the Agents can accept responsibility for errors or omissions. The sketch is for illustration purposes only and intending purchasers should satisfy themselves independently regarding sizes, layout and location of the property. Please check with local council that all structures are approved by council.

