



**WILLASTON - The Enchanted Allotment**

\$380,000

This charming yet modest home of brick and log construction is set on a huge, almost-acre allotment (3,357m2). Built in 1975, the ranch-style house comprises of a formal lounge with open fireplace, a solid timber country kitchen with electric oven and hot plates, meals area, and three bedrooms, including main with built-in robe. There is also a formal dining, which could become another bedroom if so desired. Together with bathroom offering separate toilet with vanity, and built-in laundry off the meals area, this much loved home is complete.

Timber decking and verandahs both front and rear allow for full enjoyment of the magnificent gardens and massive expanse of land. The property boasts numerous structures and sheds, one of which is lined to make a 6m x 6m games room / rumpus, and a 3m x 3m office or sleep out. The allotment has been beautifully established by the only owners over many years, with fernery, glass houses, potting sheds, aviaries, and even a large garden of cacti!

As a corner block with over 134m of road frontage and multiple accesses, this property would suit many buyers needs and could be developed (subject to council consent).

Seeing is believing - call Kies to arrange your appointment to suit!

RLA: 249396

**Upcoming Inspections**

Inspect by appointment, contact agent.

**Land Size**

3357 m2

**Kies Real Estate**

enquiries@kies.com.au

08 8523 3777

3A Adelaide Road, Gawler 5118

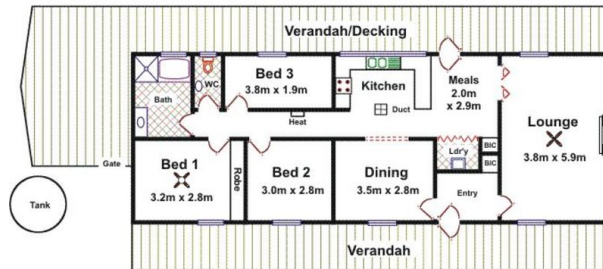
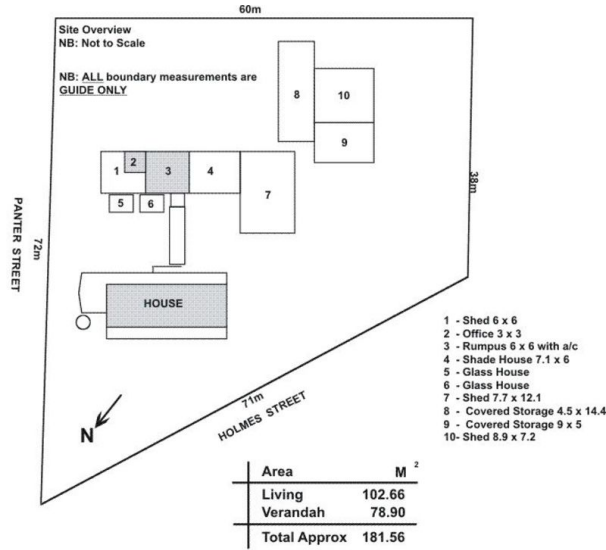

Please Note: Every care has been taken to verify the correctness of the areas and details used in this leaflet. No warranty or representation is given or made as to the correctness of the information supplied and neither the owners, illustrator nor the Agents can accept responsibility for errors or omissions. The sketch is for illustration purposes only and intending purchasers should satisfy themselves independently regarding sizes, layout and location of the property. Please check with local council that all structures are approved by council.

