

### TRURO - Something Special

\$359,950

Set well back from the road on over half an acre of land (2,154m<sup>2</sup>), this four year old home is not to be missed! Of steel frame construction, the home has been beautifully established with tasteful neutral decor and immaculate presentation - a true credit to the current owners.

Boasting nearly 18 squares of living space, the home includes three bedrooms - master with walk-in-robe and ensuite - and two living areas. The modern kitchen overlooks the open plan living and dining area, and features walk-in-pantry, breakfast bar, stainless steel dishwasher, and 900mm gas cooktop. Spotted Gum hardwood floors are a stunning feature throughout the home, which is serviced by ducted reverse-cycle air-conditioning.

For the shed lovers there is a huge 7m x 9m garage at the end of the driveway, with plenty of clearance for a boat or caravan. There is also a double carport under the main roof providing a great deal of secure parking. The front and back yards have been landscaped with a variety of trees and shrubs, as well as lawned areas, and the whole property is securely fenced. With no neighbours behind, the property feels very private and is awarded with fantastic views over the farm land.

If this sounds like your dream home, call Kies today to arrange your own private viewing!

RLA: 249396

### Upcoming Inspections

Inspect by appointment, contact agent.

### Land Size

2154 m<sup>2</sup>

### Kies Real Estate

[enquiries@kies.com.au](mailto:enquiries@kies.com.au)

08 8523 3777

3A Adelaide Road, Gawler 5118

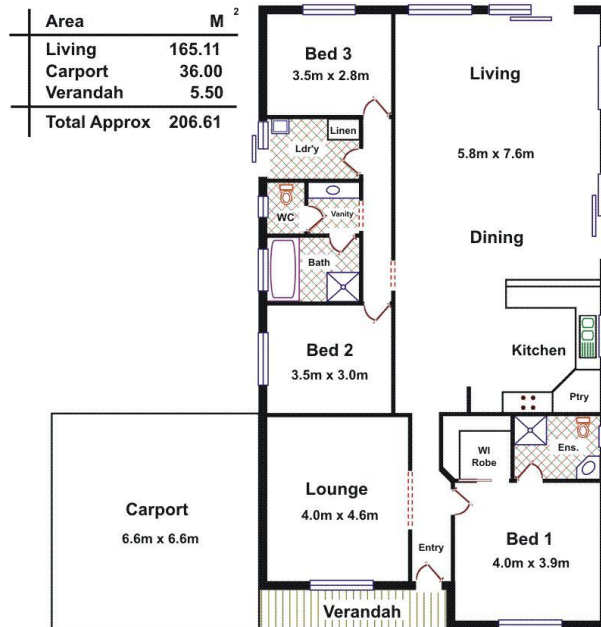

Please Note: Every care has been taken to verify the correctness of the areas and details used in this leaflet. No warranty or representation is given or made as to the correctness of the information supplied and neither the owners, illustrator nor the Agent accept responsibility for errors or omissions. The sketch is for illustration purposes only and intending purchasers should satisfy themselves independently regarding sizes, layout and location of the property. Please check with local council that all structures are approved by council.

