

**HILLBANK - How Much Room Do You Want?!?**

\$427,950

Set on 630m<sup>2</sup>, this quality home boasts a magnificent 25 squares of open living space. The home includes five bedrooms, including master featuring walk-in robe and ensuite with spa. The convenient three-way family bathroom is situated between bedrooms 2, 3 and 4, away from the family areas.

There are three separate living areas, including formal lounge, and formal dining at the front of the house, plus an enormous family/games/meals area adjacent to the Blackwood kitchen. At the heart of the home, the fabulous kitchen offers vast amounts of cupboard space, breakfast bar, and stainless steel appliances including dishwasher. The home is serviced by ducted gas heating and evaporative air conditioning that takes care of all of your heating and cooling needs.

Outside is also impressive, with a double garage under the main roof, and a spacious pitched roof verandah running along the side of the home, perfect for entertaining! Established gardens and two garden sheds complete the home.

This five bedroom home is in a family-friendly location, amongst other neatly established homes - hard to beat! Call Kies today to arrange your private inspection.

RLA 249396

**Upcoming Inspections**

Inspect by appointment, contact agent.

**Land Size**

630 m<sup>2</sup>

**Kies Real Estate**

[enquiries@kies.com.au](mailto:enquiries@kies.com.au)

08 8523 3777

3A Adelaide Road, Gawler 5118

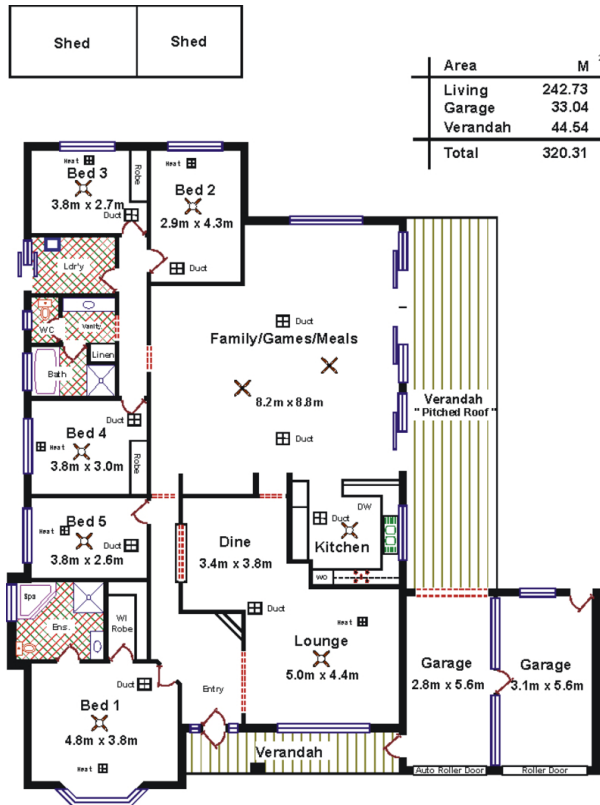

**Please Note:** Every care has been taken to verify the correctness of the areas and details used in this leaflet. No warranty or representation is given or made as to the correctness of the information supplied and neither the owners, illustrator nor the Agent accept responsibility for errors or omissions. The sketch is for illustration purposes only and intending purchasers should satisfy themselves independently regarding sizes, layout and location of the property. Please check with local council that all structures are approved by council.

