



ELIZABETH VALE - Clean as a Whistle

\$219,950

Conveniently located within walking distance of Lyell McEwin Hospital, this solid brick home could be a shrewd investment, the perfect home, or both!

Boasting 3 double bedrooms, main with parent's retreat that could be used as a study or even a 4th bedroom, a large formal lounge with floating timber floors, as does the modern kitchen and dining. Together with recently refurbished bathroom and new carpets, this is a home ready for its new owner.

Outside features a rear verandah and pergola, with established gardens and manicured lawns plus a double length carport. With heating and cooling this property is complete, clean and convenient.

Move straight in or rent out immediately, either way it's a win-win situation. Call today to arrange an inspection to suit.

RLA 249396

Upcoming Inspections

Inspect by appointment, contact agent.

Land Size

512 m2

Kies Real Estate

enquiries@kies.com.au

08 8523 3777

3A Adelaide Road, Gawler 5118

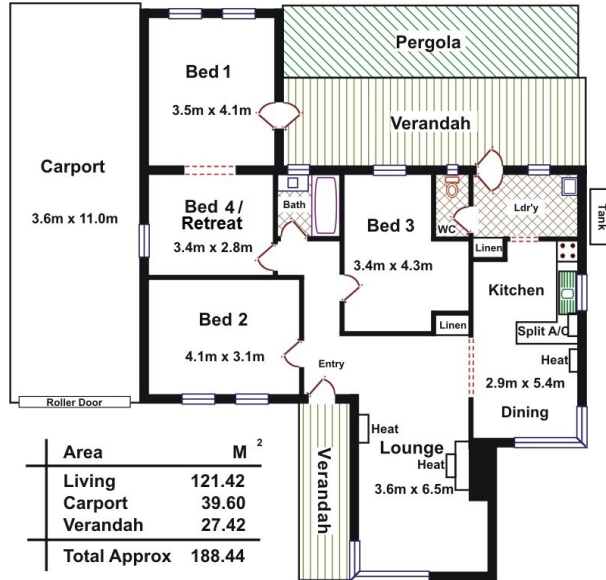

Please Note: Every care has been taken to verify the correctness of the areas and details used in this leaflet. No warranty or representation is given or made as to the correctness of the information supplied and neither the owners, illustrator nor the Agent accept responsibility for errors or omissions. The sketch is for illustration purposes only and intending purchasers should satisfy themselves independently regarding sizes, layout and location of the property. Please check with local council that all structures are approved by council.

