



## LYNDOCH - Exceptional Quality

\$399,950

Set on over quarter of an Acre, this stunning brick veneer home oozes quality with oak timber floors, high ceilings, ornate cornices and only the best fixtures and fittings throughout.

Boasting 3 double bedrooms, one with built-in robe, two with walk-in robes and main with ensuite, there is abundant living space alike, with formal lounge, formal dining together with open kitchen/meals and family area which is sure to be the hub of this beautiful home. It is a true credit to its current (and ONLY) owners who have meticulously maintained and kept the property since building it in 1998.

The home also features reverse cycle heating and cooling , stainless steel kitchen appliances, dishwasher, double garage under the main roof with automatic roller door, side access and as expected with a property of the calibre, irrigated park-like gardens with mature trees and shrubs, and manicured lawns.

Inspection is sure to impress and can be arranged by appointment. Call today to arrange a time to suit.

RLA 249396

## Upcoming Inspections

Inspect by appointment, contact agent.

## Land Size

1014 m2

## Kies Real Estate

[enquiries@kies.com.au](mailto:enquiries@kies.com.au)

08 8523 3777

3A Adelaide Road, Gawler 5118

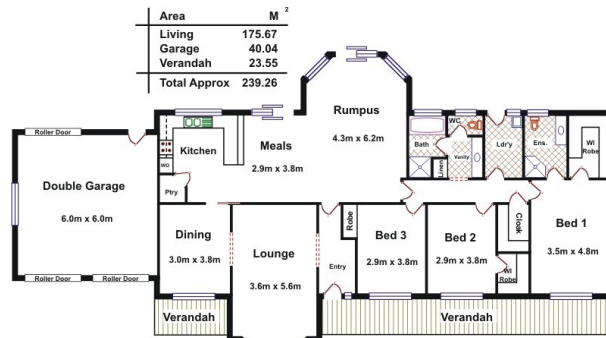

Please Note: Every care has been taken to verify the correctness of the areas and details used in this leaflet. No warranty or representation is given or made as to the correctness of the information supplied and neither the owners, illustrator nor the Agent accept responsibility for errors or omissions. The sketch is for illustration purposes only and intending purchasers should satisfy themselves independently regarding sizes, layout and location of the property. Please check with local council that all structures are approved by council.

