



GAWLER EAST - Half An Acre To Develop Your Dream

\$469,950

Presenting a beautiful Sterling built home, less than 10 years young, and almost four times the size of the normal land offering the prestigious suburb of Gawler East. Set on half an acre this 5 bedroom home is a blank canvas that offers the opportunity to paint your masterpiece. This home is perfect for the growing family, or tradesperson looking for a large allotment and shedding.

This spacious home boasts five bedrooms including master with bay window, walk-in robe and ensuite, and bedrooms 2 and 3 with built in robes. The large formal lounge flows through to the open plan area with the kitchen complete with walk-in pantry, electric oven, dishwasher and raised breakfast bar overlooking the dining/family area. With neutral decor throughout the home.

Outdoors all the hard work is done, with a concrete plinth ready for an entertaining area, Colorbond 40 x 20 shed with cement floor, and a few mature trees that could be incorporated into your landscaping. Not to mention there is plenty of room for a swimming pool or even a tennis court. The 1.8m Colorbond fences border the property, and with side access that would accommodate any large vehicle, boat, caravan or trailer.

Serviced by reverse cycle ducted heating and cooling, and save on costs with the 4Kw solar system contributing to the power bills.

RLA 249396

Upcoming Inspections

Inspect by appointment, contact agent.

Land Size

2001 m2

Kies Real Estate

enquiries@kies.com.au

08 8523 3777

3A Adelaide Road, Gawler 5118

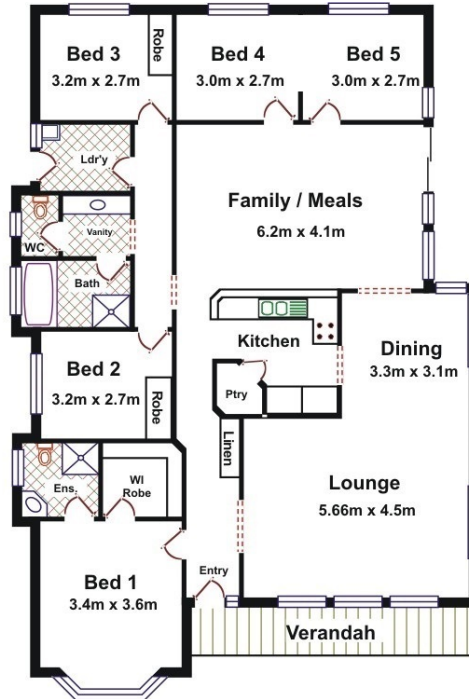

Please Note: Every care has been taken to verify the correctness of the areas and details used in this leaflet. No warranty or representation is given or made as to the correctness of the information supplied and neither the owners, illustrator nor the Agent accept responsibility for errors or omissions. The sketch is for illustration purposes only and intending purchasers should satisfy themselves independently regarding sizes, layout and location of the property. Please check with local council that all structures are approved by council.

