



GAWLER SOUTH - Character Home on Large Allotment

\$319,950

Location, location, just walking distance to shops, transport and all of Gawler's amenities. This solid brick 3 bedroom home has been residence to the same family since its completion in 1953. Boasting ten foot (10') ceilings and stunning timber floorboards this property is ripe for renovation that will certainly reap rewards. Set on over 800m² with side, and rear accesses, the property would suit buyers requiring room for cars, caravans or recreational vehicles.

With vision and hard work this house could once again be something very special, with its sparrow-pecked sandstone frontage and exquisite original lead light windows.

The home offers two split system and an original fireplace with slow/combustion heating, together with a large rear verandah and ample shedding. It's well worth an inspection.

Call today to arrange an time to suit!

RLA: 249396

Upcoming Inspections

Inspect by appointment, contact agent.

Land Size

827 m²

Kies Real Estate

enquiries@kies.com.au

08 8523 3777

3A Adelaide Road, Gawler 5118

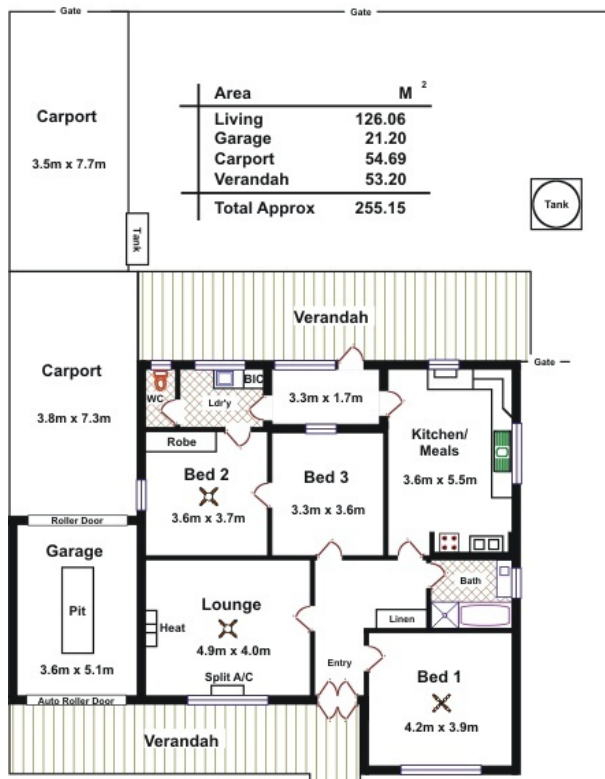
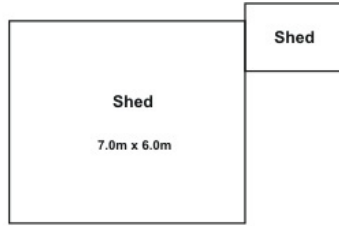

Please Note: Every care has been taken to verify the correctness of the areas and details used in this leaflet. No warranty or representation is given or made as to the correctness of the information supplied and neither the owners, illustrator nor the Agent accept responsibility for errors or omissions. The sketch is for illustration purposes only and intending purchasers should satisfy themselves independently regarding sizes, layout and location of the property. Please check with local council that all structures are approved by council.

