



NURIOOTPA - A Matter of Lifestyle!

\$285,000

If you are looking for a rural family home on an old fashioned large block of 746m² then this property should be on your list. Located in the beautiful Barossa Valley, this refurbished home is the ideal place to raise your family, being conveniently close to quality schools, child-care, parks, and the Co-op shopping centre.

Ideal for the growing family this immaculately presented home boasts.

The home features a spacious lounge, set with a huge slow combustion heater for those cold winter nights. 3 good size bedrooms, all with ceiling fans and are set away from the main living areas along with the large family bathroom. The home is complete with an open plan kitchen with breakfast bar and ample cupboard space.

Stepping out through the sliding doors you are greeted by the large side and rear veranda pitched roof entertaining area, the perfect space for family gatherings.

Outside the star is a 9.2m*6.2m garage/workshop with concrete and power a spacious backyard for the family to play all surrounded by established gardens for low maintenance living. There is also side access to the property ideal to house a boat or caravan.

This home is ideal for investors to add to their portfolio or first home buyers or those wishing to downsize to a low maintenance property.

RLA: 249396

Upcoming Inspections

Inspect by appointment, contact agent.

Land Size

746 m²

Kies Real Estate

enquiries@kies.com.au

08 8523 3777

3A Adelaide Road, Gawler 5118

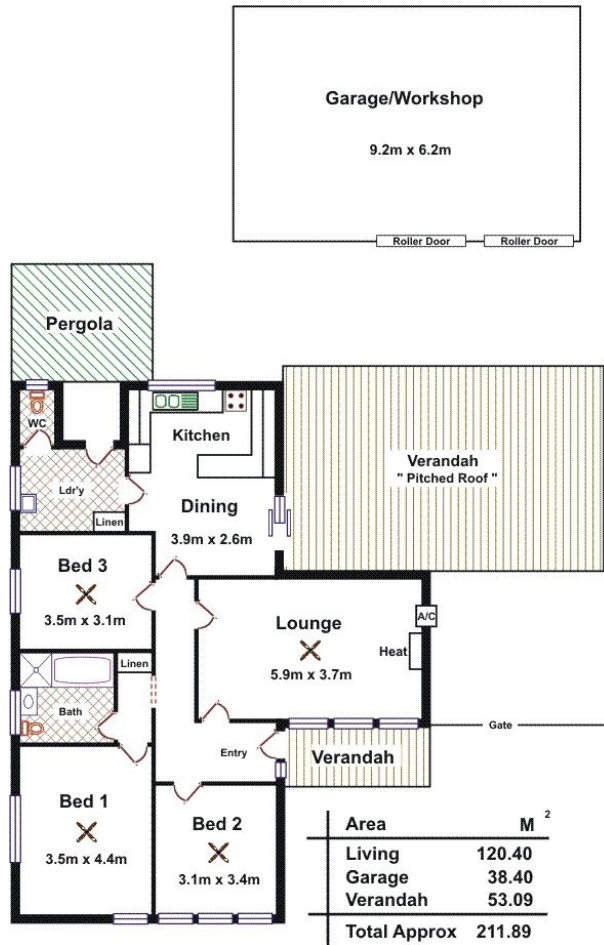

Please Note: Every care has been taken to verify the correctness of the areas and details used in this leaflet. No warranty or representation is given or made as to the correctness of the information supplied and neither the owners, illustrator nor the Agent accept responsibility for errors or omissions. The sketch is for illustration purposes only and intending purchasers should satisfy themselves independently regarding sizes, layout and location of the property. Please check with local council that all structures are approved by council.

