



Idyllic Family Living

\$449,950

This wonderful, immaculately presented family home is set on a generous 694m² allotment, with easy access to major roads and public transport. Located in the quiet and leafy suburb of St Agnes, the property is a stone's throw from six quality schools, recreational/sporting facilities and only 5 minutes from Tea Tree Plaza Shopping centre.

This charming Tudor home features 3 spacious bedrooms upstairs, master with walk in robe and ensuite, bedrooms 2 & 3 with huge built in robes and located next to the family bathroom.

Downstairs is enormous!!! With a neat modern central kitchen, formal lounge and dining, and second family/living room (with the potential of 5th bedroom from its original design) and 3rd bathroom complete the home.

The current owners have achieved a fantastic job in modernising the home including an updated kitchen, newly renovated bathrooms and polished floorboards throughout.

To top it all off, outside there is a large rear verandah for all you're entertaining needs, double enclosed carport all surrounded by established gardens for low maintenance living.

Perfect for the growing teenager or extra family members the home offers a lined teenage/retreat ? granny flat, and home handyman work shop.

A quality family property in a fantastic location such as this will not last long. Call us today before you miss out!

RLA 249396

Upcoming Inspections

Inspect by appointment, contact agent.

Land Size

694 m²

Kies Real Estate

enquiries@kies.com.au

08 8523 3777

3A Adelaide Road, Gawler 5118

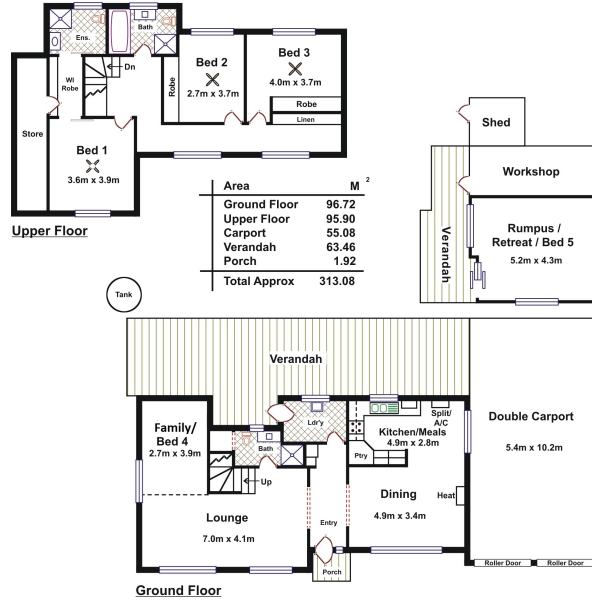

Please Note: Every care has been taken to verify the correctness of the areas and details used in this leaflet. No warranty or representation is given or made as to the correctness of the information supplied and neither the owners, illustrator nor the Agent, accept responsibility for errors or omissions. The sketch is for illustration purposes only and intending purchasers should satisfy themselves independently regarding sizes, layout and location of the property. Please check with local council that all structures are approved by council.

